

We're Fully Booked

Due to the volume of interest on this property we are unable to offer any further viewings at this time.

jordan fishwick

FLAT 6 80 - 82 BARTON ROAD STRET福德 MANCHESTER
PCM £750 PČM

FLAT 6 80 - 82 BARTON ROAD STRETFORD MANCHESTER M32 9AE

AVAILABLE NOW - Barton Road, Streford

Jordan Fishwick are pleased to bring to the market this well presented and spacious one bedroom basement flat on Barton Road in Stretford. In brief the property comprises; private entrance door, lounge, kitchen with appliances, bedroom and separate shower room with shower and WC. The property also benefits from electric heating, double glazing and off road parking for one car. Offered on an unfurnished basis. Call now to view - 0161 976 5080

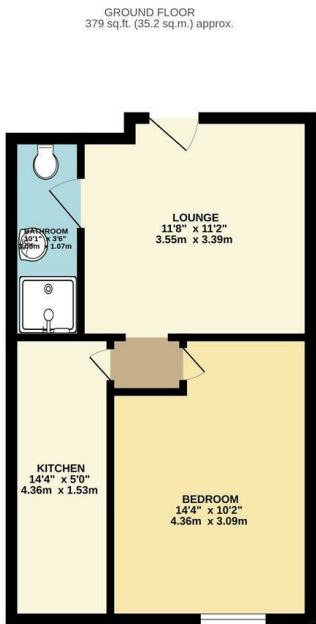

TOTAL FLOOR AREA: 379 sq.ft. (35.2 sq.m.) approx.
Measurements are approximate. Not to scale. Not for contract. For illustrative purposes only.
Made with SketchUp 2022

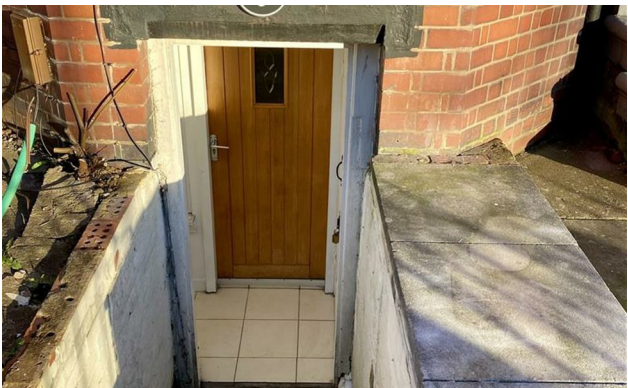

- AVAILABLE NOW
- One Bedroom Basement Flat
- Parking To The Rear
- EPC Rating E
- Close To Transport Links
- Tax Band A
- Private Entrance

